

DB32 Refuse Vehicle	
Overall Length	7.900m
Overall Width	2.400m
Overall Body Height	3.183m
Min Body Ground Clearance	0.388m
Max Track Width	2.400m
Lock to lock time	6.00s
Kerb to Kerb Turning Radius	9.625m

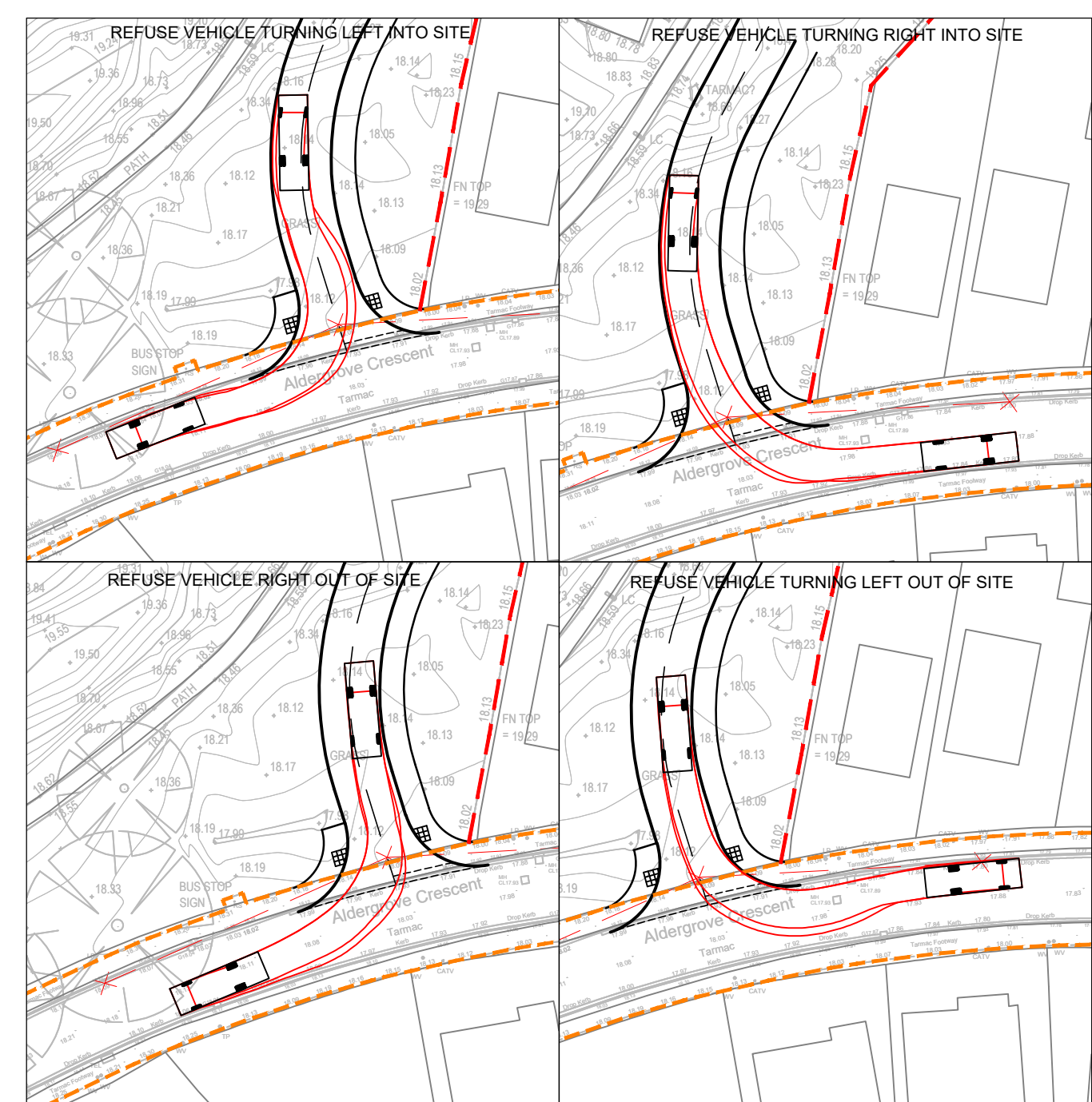

Rev	Description	Date

Project:	Proposed Residential Development Jasmin Green, Birchwood
Title:	Proposed Access Junction Layout (Option 2)

Client:	Lincs Design Consultancy
---------	--------------------------

ADC
INFRASTRUCTURE

Dwg Size:	Scale:	Date:
A3	1:500	10/02/2020
Dwg No:	Rev:	
ADC2180-DR-002	P1	